

Product information

- balancing quality: G6.3 / 15,000 rev./min
- dimensions to DIN 69882-4
- with bore to DIN 1835-2 form B "Weldon"
- from bore d1 = 25 with two clamping screws
- HSK-A to ISO 12164-1 / DIN 69893-1

Scope of delivery

- incl. clamping screw article no. 4903
- order coolant supply set, article no. 4949 separately

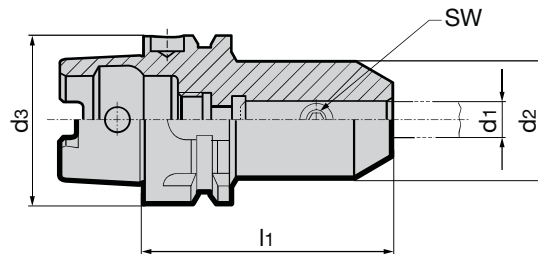

Series no. **4329**

HSK-A d ₃	clamping-Ø d ₁ H5 mm	d ₂ mm	d ₄ mm	l ₁ mm	SW	kg	Code no.	EDP Number
32	6	25	15	60	3	0.24	6.032	9043290060320
32	8	28	20	60	4	0.27	8.032	9043290080320
32	10	35	25	65	5	0.31	10.032	9043290100320
32	12	42	30	65	6	0.41	12.032	9043290120320
40	6	25	15	60	3	0.33	6.040	9043290060400
40	8	28	20	60	4	0.35	8.040	9043290080400
40	10	35	25	60	5	0.47	10.040	9043290100400
40	12	42	30	70	6	0.58	12.040	9043290120400
40	14	44	32	75	6	0.59	14.040	9043290140400
40	16	48	36	75	6	0.64	16.040	9043290160400
50	6	25	15	65	3	0.52	6.050	9043290060500
50	8	28	20	65	4	0.55	8.050	9043290080500
50	10	35	25	65	5	0.62	10.050	9043290100500
50	12	42	30	80	6	0.87	12.050	9043290120500
50	14	44	32	80	6	0.90	14.050	9043290140500
50	16	48	36	80	6	0.94	16.050	9043290160500
50	18	50	38	80	6	0.96	18.050	9043290180500
50	20	52	40	80	8	0.97	20.050	9043290200500
63	6	25	15	65	3	0.81	6.063	9043290060630
63	8	28	20	65	4	0.83	8.063	9043290080630
63	10	35	25	65	5	0.89	10.063	9043290100630
63	12	42	30	80	6	1.20	12.063	9043290120630
63	14	44	32	80	6	1.20	14.063	9043290140630
63	16	48	36	80	6	1.30	16.063	9043290160630
63	18	50	38	80	6	1.35	18.063	9043290180630
63	20	52	40	80	8	1.40	20.063	9043290200630
63	25	65	45	110	10	2.40	25.063	9043290250630
63	32	72	56	110	10	2.70	32.063	9043290320630
80	6	25	15	80	3	1.75	6.080	9043290060800
80	8	28	20	80	4	1.90	8.080	9043290080800
80	10	35	25	80	5	2.10	10.080	9043290100800
80	12	42	30	80	6	2.10	12.080	9043290120800
80	14	44	32	80	6	2.30	14.080	9043290140800
80	16	48	36	100	6	2.50	16.080	9043290160800
80	18	50	38	100	6	2.50	18.080	9043290180800
80	20	52	40	100	8	2.70	20.080	9043290200800
80	25	65	45	100	10	2.80	25.080	9043290250800
80	32	72	56	110	10	2.85	32.080	9043290320800
80	40	80	60	120	10	2.98	40.080	9043290400800
100	6	25	15	80	3	3.00	6.100	9043290061000
100	8	28	20	80	4	3.20	8.100	9043290081000
100	10	35	25	80	5	3.40	10.100	9043290101000
100	12	42	30	80	6	3.40	12.100	9043290121000
100	14	44	32	80	6	3.50	14.100	9043290141000
100	16	48	36	100	6	3.80	16.100	9043290161000
100	18	50	38	100	6	3.80	18.100	9043290181000
100	20	52	40	100	8	3.90	20.100	9043290201000
100	25	65	45	100	10	3.90	25.100	9043290251000
100	32	72	56	100	10	4.20	32.100	9043290321000
100	40	80	60	110	10	4.60	40.100	9043290401000