

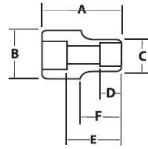

TOOLS @ HEIGHT
DROP PREVENTION SYSTEM

Side hole in socket permits use with Snap-on Industrial Brands Tools@Height drive tools such as ratchets, extensions and u-joints



3/8" DRIVE DEEP IMPACT SOCKETS, 6 POINT, METRIC

Black Industrial Finish

Product Code	Size (MM)	Dimensions						
		A (Inches)	B Drive End Diameter (Inches)	C Working End Diameter (Inches)	D Broach Depth (Inches)	E Bolt Clearance Depth (Inches)	F Bolt Clearance Diameter (Inches)	Nose Length (Inches)
36707	7	2 1/2	3/4	7/16	15/32	1 23/32	1/4	7/16
36708	8	2 1/2	3/4	1/2	9/16	1 23/32	9/32	7/16
36709	9	2 1/2	3/4	1/2	19/32	1 23/32	5/16	7/16
36710	10	2 1/2	3/4	5/8	1	1 23/32	3/8	7/16
36711	11	2 1/2	3/4	21/32	1 1/16	1 23/32	13/32	7/16
36712	12	2 1/2	3/4	23/32	1	1 23/32	7/16	7/16
36713	13	2 1/2	7/8	29/32	1 3/16	2	1/2	7/16
36714	14	2 1/2	7/8	13/16	1 1/32	2	17/32	-
36715	15	2 1/2	7/8	7/8	1 1/16	2	9/16	-
36716	16	2 1/2	15/16	15/16	1 1/32	2	19/32	-
36717	17	2 1/2	15/16	15/16	1 1/32	2	21/32	-
36718	18	2 1/2	1	1	1	2	11/16	-
36719	19	2 1/2	1 1/16	1 1/16	1	2	23/32	-

36908 10 Piece 3/8" Drive Deep 6 Point Impact Socket Set on Clip Rail

Contents Include:

Product Code	Size (MM)	Product Code	Size (MM)	Product Code	Size (MM)
36710	10	36714	14	36718	18
36711	11	36715	15	36719	19
36712	12	36716	16		
36713	13	36717	17		

Features

- SUPERTORQUE® lobular openings for greater turning power without deforming the fastener.
- Designed for maximum engagement on 6 point fasteners.
- Suitable for use with pneumatic and electric impact wrenches.
- Specially heat treated for impact use to provide long life, safety, and durability.
- Drive end features pin retention hole and groove.



TOOLS @ HEIGHT
DROP PREVENTION SYSTEM

Side hole in socket permits use with Snap-on Industrial Brands Tools@Height drive tools such as ratchets, extensions and u-joints



3/8" DRIVE DEEP IMPACT SOCKETS, 12 POINT, MM

Black Industrial Finish

Product Code	Size (mm)	Dimensions						
		A Overall Length (Inches)	B Drive End Diameter (Inches)	C Working End Diameter (Inches)	D Broach Depth (Inches)	E Bolt Clearance Depth (Inches)	F Bolt Clearance Diameter (Inches)	Nose Length (Inches)
35407	7	2 1/2	3/4	1/2	1/2	/	1/4	1 1/4
35408	8	2 1/2	3/4	1/2	1/2	/	1/4	1 1/4
35409	9	2 1/2	3/4	1/2	1/2	/	1/4	1 1/4
35410	10	2 1/2	3/4	1/2	3/4	/	3/8	1 1/4
35411	11	2 1/2	3/4	1/2	3/4	/	3/8	1 1/4
35412	12	2 1/2	3/4	3/4	3/4	/	3/8	/
35413	13	2 1/2	3/4	3/4	7/8	/	1/2	/
35414	14	2 1/2	3/4	3/4	7/8	/	1/2	/
35415	15	2 1/2	7/8	7/8	1	/	1/2	/
35416	16	2 1/2	7/8	7/8	1	/	1/2	/
35417	17	2 1/2	7/8	7/8	1	/	1/2	/
35418	18	2 1/2	7/8	7/8	1	/	5/8	/
35419	19	2 1/2	1	1	1	/	5/8	/

36924 13 Piece 3/8" Drive Deep 12 point Impact Socket Set on Clip and Rail

Contents Include:

Product Code	Size (MM)	Product Code	Size (MM)	Product Code	Size (MM)
35407	7	35411	11	35415	15
35408	8	35412	12	35416	16
35409	9	35413	13	35417	17
35410	10	35414	14	35418	18
				35419	19

Features

- SUPERTORQUE® lobular openings for greater turning power without deforming the fastener.
- Designed for maximum engagement on 6 or 12 point fasteners.
- Suitable for use with pneumatic and electric impact wrenches.
- Specially heat treated for impact use to provide long life, safety, and durability.
- Drive end features pin retention hole and groove.



3/8" DRIVE

SOCKETS AND DRIVE TOOLS