



1/2" DRIVE DEEP SOCKETS, 12 POINT, SAE

High-Polished Chrome Finish

Product Code	Size (Inches)	A OAL (Inches)	B Drive End Diameter (Inches)	C Working End Diameter (Inches)	D Broach Depth (Inches)	E Bolt Clearance Depth (Inches)	Bolt Clearance Diameter (Inches)	F Nose Length (Inches)
32412	3/8	3	7/8	5/8	1	2 7/32	1 1/32	1 15/32
32414	7/16	3 1/32	7/8	1 1/16	1 1/8	2 9/32	1 9/32	1 15/32
32416	1/2	3 1/32	7/8	3/4	3 1/32	2 7/32	7/16	1 15/32
32418	9/16	3 1/32	7/8	13/16	1 3/32	2 7/32	1/2	1 15/32
32420	5/8	3 1/32	29/32	29/32	1 3/16	2 9/16	9/16	-
32422	1 1/16	3 1/32	15/16	15/16	1 3/8	2 3/16	2 1/32	-
32424	3/4	3 1/32	1 1/16	1 1/16	1 1/4	2 1 1/32	2 3/32	-
32426	13/16	3 1/32	1 1/8	1 1/8	1 15/32	2 3/16	3/4	-
32428	7/8	3 1/32	1 3/16	1 3/16	1 13/32	2 1/4	2 1/32	-
32430	15/16	3 1/32	1 1/4	1 1/4	1 13/32	2 5/32	2 3/32	-
32432	1	3 1/32	1 1 1/32	1 1 1/32	1 13/32	2 3/32	1 9/16	-
32434	1 1/16	3 1/32	1 13/32	1 13/32	1 3/8	2 1 1/32	1 1/32	-
32436	1 1/8	3 1/32	1 1/2	1 1/2	1 7/16	2 3/8	1 1/16	-
32438	1 3/16	3 1/32	1 9/16	1 9/16	1 7/16	2 3/16	1 1/16	-
32440	1 1/4	3 1/32	1 2 1/32	1 2 1/32	1 7/16	2 3/16	1 1/16	-
32442	1 5/16	3 1/32	1 47/64	1 47/64	1 3/8	2 1 1/64	1 3/16	-
32444	1 3/8	3 1/32	1 53/64	1 53/64	1 3/8	2 1 1/64	1 17/64	-
32446	1 7/16	3 1/32	1 57/64	1 57/64	1 3/8	2 1 1/64	1 1 1/32	-
32448	1 1/2	3 1/32	1 15 1/16	1 3 1/32	1 7/16	2 3/16	1 1/16	-

Fed. Spec: ANSI B107.1

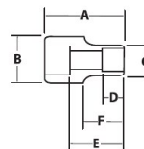

32926 9 Piece 1/2" Drive Deep 12 Point Socket Set on Clip Rail

Contents Include:

Product Code	Size (Inches)	Product Code	Size (Inches)	Product Code	Size (Inches)
32416	1/2	32422	1 1/16	32428	7/8
32418	9/16	32424	3/4	32430	15/16
32420	5/8	32426	13/16	32432	1



32928 16 Piece 1/2" Drive Deep 12 Point Socket Set on Clip Rail

Contents Include:

Product Code	Size (Inches)	Product Code	Size (Inches)	Product Code	Size (Inches)	Product Code	Size (Inches)
32412	3/8	32420	5/8	32428	7/8	32436	1 1/8
32414	7/16	32422	1 1/16	32430	15/16	32438	1 3/16
32416	1/2	32424	3/4	32432	1	32440	1 1/4
32418	9/16	32426	13/16	32434	1 1/16	32448	1 1/2



32929 19 piece 1/2" Drive Shallow 12 Point Socket Set on Clip Rails

Contents Include:

Product Code	Size (Inches)	Product Code	Size (Inches)	Product Code	Size (Inches)	Product Code	Size (Inches)
32412	3/8	32422	1 1/16	32432	1	32442	1 5/16
32414	7/16	32424	3/4	32434	1 1/16	32444	1 3/8
32416	1/2	32426	13/16	32436	1 1/8	32446	1 7/16
32418	9/16	32428	7/8	32438	1 3/16	32448	1 1/2
32420	5/8	32430	15/16	32440	1 1/4		



Features

- SUPERTORQUE® lobular openings for greater turning power without deforming the fastener.
- Designed for quick engagement on both 6 and 12 point fasteners.

