

JIS B6339/MAS 403-BT

JIS B6339 -BT	Taper Accuracy AT3	G Value 6.3	RPM 15,000	Coolant System AD/B
------------------	--------------------------	----------------	---------------	---------------------------

STANDARD

Unit : inch

EDP No.	TAPER No.	MODEL No.	d	L	D
EH006B	40	BT40AD/B-SMA1/2-1.75	0.500	1.75	1.44
EH010B		BT40AD/B-SMA3/4-1.77	0.750	1.77	1.69
EH014B		BT40AD/B-SMA1"-1.77	1.000	1.77	2.19
EH017B		BT40AD/B-SMA1 1/4-1.81	1.250	1.81	2.75
EH021B		BT40AD/B-SMA1 1/2-2.36	1.500	2.36	3.81
EI010	50	BT50-SMA3/4-1.75	0.750	1.75	1.69
EI014		BT50-SMA1"-1.75	1.000	1.75	2.19
EI017		BT50-SMA1 1/4-1.75	1.250	1.75	2.75
EI021		BT50-SMA1/2-1.75	1.500	1.75	3.81
EI029		BT50-SMA2"-3.00	2.000	3.00	4.88

EXTENDED

Unit : inch

EDP No.	TAPER No.	MODEL No.	d	L	D
EH306B	40	BT40AD/B-SMA1/2-3.50	0.500	3.50	1.44
EH310B		BT40AD/B-SMA3/4-4.13	0.750	4.13	1.69
EH314B		BT40AD/B-SMA1"-4.13	1.000	4.13	2.19
EH317B		BT40AD/B-SMA1 1/4-4.13	1.250	4.13	2.75
EH321B		BT40AD/B-SMA1 1/2-4.72	1.500	4.72	3.81
EI310	50	BT50-SMA3/4-3.50	0.750	3.50	1.69
EI314		BT50-SMA1"-4.00	1.000	4.00	2.19
EI317		BT50-SMA1 1/4-4.00	1.250	4.00	2.75
EI321		BT50-SMA1 1/2-4.00	1.500	4.00	3.81
EI329		BT50-SMA2"-4.00	2.000	4.00	4.88

- * High balanced Shell Mill Arbors are available on request.
- * Drive Key / Lock Screw for Shell Mill Arbors on page 120.

SHELL MILL DRIVE KEY

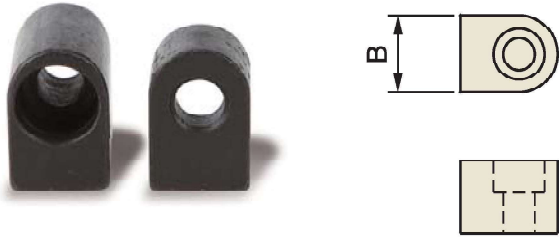

SHELL MILL DRIVE KEY

Unit : inch

EDP No.	SERIES	B
ZZ021	SMA1/2-KEY	0.25
ZZ022	SMA3/4-KEY	0.312
ZZ023	SMA1"-KEY	0.375
ZZ024	SMA1 1/4-KEY	0.5
ZZ025	SMA1 1/2-KEY	0.625
ZZ026	SMA2"-KEY	0.75

SHELL MILL LOCK SCREW

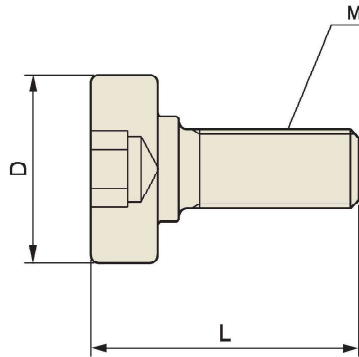

SHELL MILL LOCK SCREW

Unit : inch

EDP No.	TYPE (M)	L	D	SERIES
ZZ031	UNF1/4-28	0.906	0.618	SMA1/2-SCREW
ZZ032	UNF3/8-24	1.26	0.882	SMA3/4-SCREW
ZZ033	UNF1/2-20	1.69	1.181	SMA1"-SCREW
ZZ034	UNF5/8-18	2.05	1.5	SMA1 1/4-SCREW
ZZ035	UNF3/4-16	2.36	1.88	SMA1 1/2-SCREW
ZZ036	UN1"-14	2.52	2.5	SMA2"-SCREW

TECHNICAL INFORMATION

T.I.R and TOLERANCE

● T.I.R (Total Indicated Run-out)

HYDRAULIC CHUCK

Concentric to 0.00012" T.I.R (at 3D)

SHRINK FIT HOLDER

Concentric to 0.00012" T.I.R (at I.D)

ER COLLET CHUCK

Concentric to 0.0002" T.I.R (at I.D)

END MILL HOLDER

Concentric to 0.0002" T.I.R (at I.D)

SLITTING SAW ARBOR

Face perpendicular to taper within 0.0002" T.I.R (at I.D)

STUB ARBOR

Face perpendicular to taper within 0.0002" T.I.R (at I.D)

SHELL MILL ARBOR

Face perpendicular to taper within 0.0001" T.I.R

Out diameter to taper within 0.0002" T.I.R

MORSE & JACOBS TAPER ARBOR

Concentric to 0.0003" T.I.R

* To put tool precisely on spindle center line for getting correct T.I.R.

● AT3 or better accuracy on all shank tapers

● Accurate and rigid tool holder mounting to spindle

● The bore diameter of all tool holders is controlled by H5 grade tolerance limit.

TAPER	AT3
#30	0.000078"
#40	0.00012"
#50	0.00016"