

SHELL MILL ARBOR

CAT

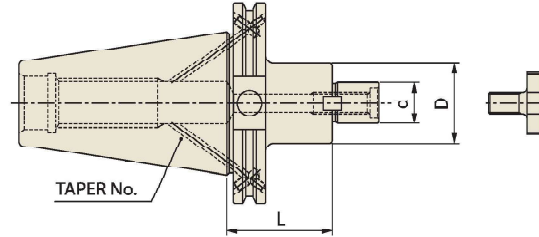

ASME B5.50
- CAT

Taper
Accuracy
AT3

G Value
6.3

RPM
15,000

Coolant
System
AD/B

ASME B5.50-2009-CAT

■ STANDARD

Unit : inch

EDP No.	TAPER No.	MODEL No.	d	L	D
EK006B	40	CAT40AD/B-SMA1/2-1.50	0.500	1.50	1.44
EK010B		CAT40AD/B-SMA3/4-1.50	0.750	1.50	1.69
EK014B		CAT40AD/B-SMA1"-2.00	1.000	2.00	2.19
EK017B		CAT40AD/B-SMA1 1/4-2.00	1.250	2.00	2.75
EK021B		CAT40AD/B-SMA1 1/2-3.00	1.500	3.00	3.81
EL010B	50	CAT50AD/B-SMA3/4-1.50	0.750	1.50	1.69
EL014B		CAT50AD/B-SMA1"-2.00	1.000	2.00	2.19
EL017B		CAT50AD/B-SMA1 1/4-2.00	1.250	2.00	2.75
EL021B		CAT50AD/B-SMA1 1/2-2.50	1.500	2.50	3.81
EL029B		CAT50AD/B-SMA2"-3.00	2.000	3.00	4.88

■ EXTENDED

Unit : inch

EDP No.	TAPER No.	MODEL No.	d	L	D
EK306B	40	CAT40AD/B-SMA1/2-3.50	0.500	3.50	1.44
EK310B		CAT40AD/B-SMA3/4-3.50	0.750	3.50	1.69
EK314B		CAT40AD/B-SMA1"-4.00	1.000	4.00	2.19
EK317B		CAT40AD/B-SMA1 1/4-4.00	1.250	4.00	2.75
EK321B		CAT40AD/B-SMA1 1/2-4.00	1.500	4.00	3.81
EL310B	50	CAT50AD/B-SMA3/4-3.50	0.750	3.50	1.69
EL314B		CAT50AD/B-SMA1"-4.00	1.000	4.00	2.19
EL317B		CAT50AD/B-SMA1 1/4-4.00	1.250	4.00	2.75
EL321B		CAT50AD/B-SMA1 1/2-4.00	1.500	4.00	3.81
EL329B		CAT50AD/B-SMA2"-4.00	2.000	4.00	4.88

* High balanced Shell Mill Arbors are available on request.

* Drive Key / Lock Screw for Shell Mill Arbors on page 120.

SHELL MILL DRIVE KEY

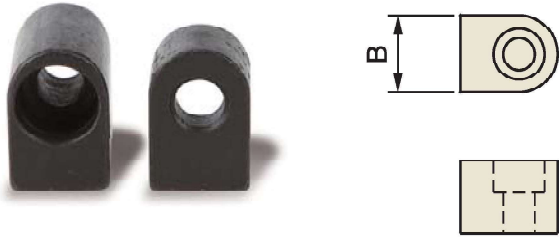

SHELL MILL DRIVE KEY

Unit : inch

EDP No.	SERIES	B
ZZ021	SMA1/2-KEY	0.25
ZZ022	SMA3/4-KEY	0.312
ZZ023	SMA1"-KEY	0.375
ZZ024	SMA1 1/4-KEY	0.5
ZZ025	SMA1 1/2-KEY	0.625
ZZ026	SMA2"-KEY	0.75

SHELL MILL LOCK SCREW

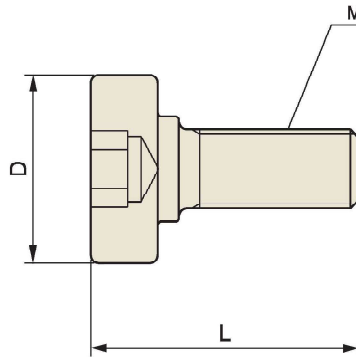

SHELL MILL LOCK SCREW

Unit : inch

EDP No.	TYPE (M)	L	D	SERIES
ZZ031	UNF1/4-28	0.906	0.618	SMA1/2-SCREW
ZZ032	UNF3/8-24	1.26	0.882	SMA3/4-SCREW
ZZ033	UNF1/2-20	1.69	1.181	SMA1"-SCREW
ZZ034	UNF5/8-18	2.05	1.5	SMA1 1/4-SCREW
ZZ035	UNF3/4-16	2.36	1.88	SMA1 1/2-SCREW
ZZ036	UN1"-14	2.52	2.5	SMA2"-SCREW

TECHNICAL INFORMATION

T.I.R and TOLERANCE

● T.I.R (Total Indicated Run-out)

HYDRAULIC CHUCK

Concentric to 0.00012" T.I.R (at 3D)

SHRINK FIT HOLDER

Concentric to 0.00012" T.I.R (at I.D)

ER COLLET CHUCK

Concentric to 0.0002" T.I.R (at I.D)

END MILL HOLDER

Concentric to 0.0002" T.I.R (at I.D)

SLITTING SAW ARBOR

Face perpendicular to taper within 0.0002" T.I.R (at I.D)

STUB ARBOR

Face perpendicular to taper within 0.0002" T.I.R (at I.D)

SHELL MILL ARBOR

Face perpendicular to taper within 0.0001" T.I.R

Out diameter to taper within 0.0002" T.I.R

MORSE & JACOBS TAPER ARBOR

Concentric to 0.0003" T.I.R

* To put tool precisely on spindle center line for getting correct T.I.R.

● AT3 or better accuracy on all shank tapers

● Accurate and rigid tool holder mounting to spindle

● The bore diameter of all tool holders is controlled by H5 grade tolerance limit.

TAPER	AT3
#30	0.000078"
#40	0.00012"
#50	0.00016"