

CARBIDE, 2 FLUTE REGULAR LENGTH

- ▶ These are designed for slotting, drilling, pocketing and general operation.
- ▶ Suitable for cutting hardened & high alloy steels, steel casting, chill casting, malleable cast iron, CrNi-steels, brass, copper, aluminum with a high percentage of silicon and abrasive plastics.

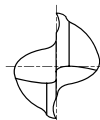

Unit : Inch

EDP No.					Mill Diameter	Shank Diameter	Length of Cut	Overall Length
UNCOATED	TiN COATED	TiCN COATED	YG:TYLON F	YG:TYLON E				
01552	01552TN	01552TC	01552TF	01552TE	1/32	1/8	5/64	1-1/2
01553	01553TN	01553TC	01553TF	01553TE	3/64	1/8	7/64	1-1/2
01554	01554TN	01554TC	01554TF	01554TE	1/16	1/8	3/16	1-1/2
01555	01555TN	01555TC	01555TF	01555TE	5/64	1/8	3/16	1-1/2
01556	01556TN	01556TC	01556TF	01556TE	3/32	1/8	3/8	1-1/2
01557	01557TN	01557TC	01557TF	01557TE	7/64	1/8	3/8	1-1/2
01558	01558TN	01558TC	01558TF	01558TE	1/8	1/8	1/2	1-1/2
01560	01560TN	01560TC	01560TF	01560TE	9/64	3/16	1/2	2
01562	01562TN	01562TC	01562TF	01562TE	5/32	3/16	9/16	2
01564	01564TN	01564TC	01564TF	01564TE	11/64	3/16	5/8	2
01565	01565TN	01565TC	01565TF	01565TE	3/16	3/16	5/8	2
01569	01569TN	01569TC	01569TF	01569TE	13/64	1/4	5/8	2-1/2
01570	01570TN	01570TC	01570TF	01570TE	7/32	1/4	5/8	2-1/2
01572	01572TN	01572TC	01572TF	01572TE	15/64	1/4	3/4	2-1/2
01573	01573TN	01573TC	01573TF	01573TE	1/4	1/4	3/4	2-1/2
01579	01579TN	01579TC	01579TF	01579TE	5/16	5/16	13/16	2-1/2
01584	01584TN	01584TC	01584TF	01584TE	3/8	3/8	1	2-1/2
01588	01588TN	01588TC	01588TF	01588TE	7/16	7/16	1	2-3/4
01593	01593TN	01593TC	01593TF	01593TE	1/2	1/2	1	3
01595	01595TN	01595TC	01595TF	01595TE	5/8	5/8	1-1/4	3-1/2
01598	01598TN	01598TC	01598TF	01598TE	3/4	3/4	1-1/2	4
01600	01600TN	01600TC	01600TF	01600TE	1	1	1-1/2	4

Mill Dia. Tolerance (inch)	Shank Dia. Tolerance
0~- .0012	0~- .0005

◎ : Excellent ○ : Good

P				H	M	K	N				S		
Carbon Steels	Alloy Steels	Prehardened Steels	Hardened Steels	High Hardened Steels	Stainless Steels	Cast Iron	Copper	Graphite	Aluminum	Acrylic	CFRP	Titanium	High Temperature Alloy
~HRc20	HRc20~30	HRc30~40	HRc40~45 HRc45~55	HRc55~70									
◎	◎	◎			○	○	○		○				

CBN END MILLS

i-Xmill END MILLS

i-SMART MODULAR TYPE END MILLS

X5070 END MILLS

4G MILL END MILLS

X-POWER END MILLS

JET-POWER END MILLS

TiAlN -POWER END MILLS

V7 PLUS A END MILLS

V7 MILL INOX END MILLS

ALU-POWER END MILLS

D-POWER GRAPHITE END MILLS

D-POWER CFRP END MILLS

ROUTERS

STANDARD CARBIDE END MILLS

ONLY ONE COATED PM60 END MILLS

SINE -POWER END MILLS

TANK-POWER END MILLS

STANDARD COBALT & HSS END MILLS

TECHNICAL DATA

CARBIDE, 2 FLUTE - SLOTTING

 CBN
END MILLS

 i-Xmill
END MILLS

 iSMART
MODULAR
TYPE END MILLS

 X5070
END MILLS

 4G MILL
END MILLS

 X-POWER
END MILLS

 JET-POWER
END MILLS

 TiTiNox
-POWER
END MILLS

 V7 PLUS A
END MILLS

 V7 MILL INOX
END MILLS

 ALU-POWER
END MILLS

 D-POWER
GRAPHITE
END MILLS

 D-POWER
CFRP
END MILLS

ROUTERS

 STANDARD
CARBIDE
END MILLS

 ONLY ONE
COATED PM60
END MILLS

 SINE -POWER
END MILLS

 TANK-POWER
END MILLS

 STANDARD
COBALT & HSS
END MILLS

 TECHNICAL
DATA

E5020, E5244, E5011, E5026, E5022, E5025 SERIES

MATERIAL	P						M		K		N			
	CARBON STEELS ALLOY STEELS TOOL STEELS		CARBON STEELS ALLOY STEELS TOOL STEELS		CARBON STEELS ALLOY STEELS TOOL STEELS		STAINLESS STEELS TITANIUM ALLOYS		CAST IRON		ALUMINUM ALLOYS		COPPER, BRASS NON-FERROUS METALS	
HARDNESS	~ HRc 20		HRc 20 ~ HRc 30		HRc 30 ~ HRc 40									
STRENGTH	500 ~ 800N/mm ²		800 ~ 10 00N/mm ²		1000 ~ 1300N/mm ²									
DIAMETER	RPM	FEED	RPM	FEED	RPM	FEED	RPM	FEED	RPM	FEED	RPM	FEED	RPM	FEED
3/32	5500	3.2	4800	2.8	4000	2.2	8000	2.6	6500	5.9	16000	12.6	12000	9.5
1/8	3700	3.5	3200	3.2	2600	2.4	5300	2.6	4200	5.9	11000	12.6	8000	9.5
5/32	2800	3.5	2400	3.2	2000	2.4	4000	2.6	3200	5.9	8000	12.6	6000	9.5
3/16	2200	3.5	1900	3.2	1600	2.4	3200	2.6	2500	5.9	6400	12.6	4800	9.5
1/4	1800	3.5	1600	3.2	1300	2.4	2600	2.6	2100	7.1	5300	13.4	4000	10.2
5/16	1400	3.5	1200	3.2	1000	2.4	2000	2.6	1600	7.5	4000	13.4	3000	10.2
3/8	1100	3.5	950	3.2	800	2.4	1600	2.6	1300	7.9	3200	13.4	2400	10.2
1/2	900	3.5	800	3.2	660	2.4	1300	2.6	1000	8.3	2600	13.4	2000	10.2
9/16	800	3.5	700	3.2	570	2.4	1100	2.6	900	8.7	2300	13.4	1700	10.2
5/8	700	3.9	600	3.4	500	3.0	1000	3.0	800	8.9	2000	13.4	1500	10.2
13/16	550	3.9	480	3.4	400	3.0	800	3.2	640	9.5	1600	13.4	1200	10.2

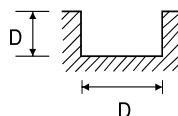

※ The Feed, in long & extra long types, should be reduced by around 50%.

RPM = rev./min. FEED = inch/min.

CARBIDE, 2 FLUTE TiAlN "F" COATED - SLOTTING
EH020, EH244, EH011, EH026, EH022, EH025 SERIES

MATERIAL	P						M		K		N			
	CARBON STEELS ALLOY STEELS TOOL STEELS		CARBON STEELS ALLOY STEELS TOOL STEELS		CARBON STEELS ALLOY STEELS TOOL STEELS		STAINLESS STEELS TITANIUM ALLOYS		CAST IRON		ALUMINUM ALLOYS		COPPER, BRASS NON-FERROUS METALS	
HARDNESS	~ HRc 20		HRc 20 ~ HRc 30		HRc 30 ~ HRc 40									
STRENGTH	500 ~ 800N/mm ²		800 ~ 1000N/mm ²		1000 ~ 1300N/mm ²									
DIAMETER	RPM	FEED	RPM	FEED	RPM	FEED	RPM	FEED	RPM	FEED	RPM	FEED	RPM	FEED
3/32	8640	4.7	7440	4.3	6240	3.3	12000	4.0	10200	9.4	24000	19.9	18000	14.6
1/8	5760	5.7	5040	5.0	4080	3.8	8280	4.0	6600	9.4	16800	19.9	12000	14.6
5/32	4370	5.7	3720	5.0	3120	3.8	6240	4.0	5040	9.4	12000	19.9	9600	14.6
3/16	3430	5.7	3000	5.0	2400	3.8	5040	4.0	3960	9.4	9960	19.9	7440	14.6
1/4	2880	5.7	2400	5.0	2040	3.8	4080	4.0	3240	10.9	8280	20.8	6240	16.1
5/16	2160	5.7	1800	5.0	1560	3.8	3120	4.0	2400	11.8	6240	20.8	4800	16.1
3/8	1680	5.7	1440	5.0	1200	3.8	2400	4.0	2040	12.3	5040	20.8	3720	16.1
1/2	1440	5.7	1200	5.0	1030	3.8	2040	4.0	1560	12.8	4080	20.8	3120	16.1
9/16	1200	5.7	1080	5.0	890	3.8	1680	4.0	1440	13.2	3600	20.8	2640	16.1
5/8	1080	6.1	960	5.2	780	4.7	1560	4.8	1200	13.7	3120	20.8	2400	16.1
13/16	880	6.1	740	5.2	620	4.7	1200	4.8	1000	14.6	2400	20.8	1870	16.1

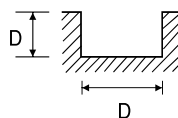

※ The Feed, in long & extra long types, should be reduced by around 50%.

RPM = rev./min. FEED = inch/min.