

DUAL CONTACT END MILL HOLDER (SPRAY NOZZLE TYPE)

HSK

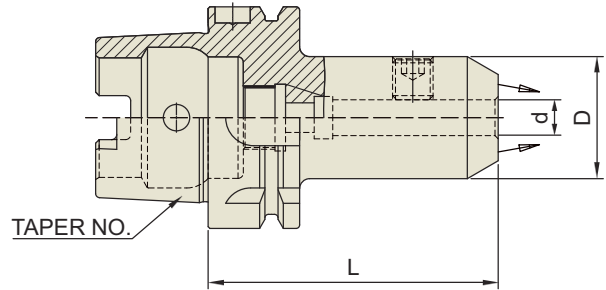

End Mill Holder &
Side Lock Arbor

DIN 69893 - HSK	Taper Accuracy	G Value 2.5	RPM 25,000	Coolant System AD+C
--------------------	-------------------	-----------------------	----------------------	----------------------------------

■ DIN 69893/ISO 12164-1-HSK FORM A

Unit : inch

EDP No.	TAPER No.	MODEL No.	d	D	L	
AQ020C	63A	HSK63A - EMH1/4C-2,56	0,250	0,780	2,559	
AQ022C		HSK63A - EMH5/16C-2,56	0,313	0,880	2,559	
AQ024C		HSK63A - EMH3/8C-2,56	0,375	1,000	2,559	
AQ026C		HSK63A - EMH1/2C-3,15	0,500	1,250	3,150	
AQ028C		HSK63A - EMH5/8C-3,15	0,625	1,500	3,150	
AQ030C		HSK63A - EMH3/4C-3,15	0,750	1,750	3,150	
AQ032C		HSK63A - EMH1C-4,33	1,000	2,000	4,331	
AQ034C		HSK63A - EMH1-1/4C-4,33	1,250	2,500	4,331	
AR020C		100A	HSK100A - EMH1/4C-3,15	0,250	0,780	3,150
AR022C			HSK100A - EMH5/16C-3,15	0,313	0,880	3,150
AR024C	HSK100A - EMH3/8C-3,15		0,375	1,000	3,150	
AR026C	HSK100A - EMH1/2C-3,15		0,500	1,250	3,150	
AR028C	HSK100A - EMH5/8C-3,94		0,625	1,500	3,937	
AR030C	HSK100A - EMH3/4C-3,94		0,750	1,750	3,937	
AR032C	HSK100A - EMH1C-3,94		1,000	2,000	3,937	
AR034C	HSK100A - EMH1-1/4C-3,94		1,250	2,500	3,937	

END MILL HOLDER SCREWS

■ HEXAGON SOCKET SET SCREW (FLAT TYPE)

EDP No.	SCREW	END MILL DIA.
ZZ000	UNC#8-32	1/8
ZZ001	UNF#10-32	3/16
ZZ002	UNF1/4-28	1/4
ZZ003	UNF5/16-24	5/16
ZZ004	UNF3/8-24	3/8
ZZ005	UNF3/8-24	7/16
ZZ006	UNF7/16-20	1/2
ZZ007	UNF1/2-20	5/8
ZZ008	UNF5/8-18	3/4
ZZ009	UNF5/8-18	7/8
ZZ010	UNF3/4-16	1"
ZZ011	UNF3/4-16	1 1/4
ZZ012	UNF3/4-16	1 1/2
ZZ013	UN1"-14	2"

