

■ INCH

Unit : inch

EDP No.	TAPER No.	MODEL No.	d1	D1	D2	L	L1	G
VS010	ST1/2	ST1/2 - SFH1/8-6,30	0,125	0,394	0,500	6,299	0,354	--
VS011		ST1/2 - SFH3/16-6,30	0,188	0,394	0,500	6,299	0,472	--
VS012		ST1/2 - SFH1/4-6,30	0,250	0,394	0,500	6,299	1,417	M5x0,8mm
VS020	ST5/8	ST5/8 - SFH1/8-6,30	0,125	0,394	0,625	6,299	0,354	--
VS021		ST5/8 - SFH3/16-6,30	0,188	0,394	0,625	6,299	0,472	--
VS022		ST5/8 - SFH1/4-6,30	0,250	0,394	0,625	6,299	1,417	M5x0,8mm
VS023		ST5/8 - SFH5/16-6,30	0,313	0,472	0,625	6,299	1,535	M6x0,8mm
VS030	ST3/4	ST3/4 - SFH1/8-6,30	0,125	0,394	0,750	6,299	0,354	--
VS031		ST3/4 - SFH3/16-6,30	0,188	0,394	0,750	6,299	0,472	--
VS032		ST3/4 - SFH1/4-6,30	0,250	0,551	0,750	6,299	1,417	M5x0,8mm
VS033		ST3/4 - SFH5/16-6,30	0,313	0,551	0,750	6,299	1,535	M6x1,0mm
VS034		ST3/4 - SFH3/8-6,30	0,375	0,551	0,750	6,299	1,654	M8x1,0mm
VS035		ST3/4 - SFH1/2-6,30	0,500	0,630	0,750	6,299	1,850	M10x1,0mm
VS040	ST1	ST1 - SFH1/8-6,30	0,125	0,394	1,000	6,299	0,354	--
VS041		ST1 - SFH3/16-6,30	0,188	0,394	1,000	6,299	0,472	--
VS042		ST1 - SFH1/4-6,30	0,250	0,551	1,000	6,299	1,417	M6x1,0mm
VS043		ST1 - SFH5/16-6,30	0,313	0,551	1,000	6,299	1,535	M6x1,0mm
VS044		ST1 - SFH3/8-6,30	0,375	0,787	1,000	6,299	1,654	M8x1,0mm
VS045		ST1 - SFH1/2-6,30	0,500	0,787	1,000	6,299	1,850	M10x1,0mm
VS046		ST1 - SFH5/8-6,30	0,625	0,866	1,000	6,299	1,969	M12x1,0mm
VS050		ST1-1/4	ST1-1/4 - SFH1/8-6,30	0,125	0,394	1,250	6,299	0,354
VS051	ST1-1/4 - SFH3/16-6,30		0,188	0,394	1,250	6,299	0,472	--
VS052	ST1-1/4 - SFH1/4-6,30		0,250	0,551	1,250	6,299	1,417	M5x0,8mm
VS053	ST1-1/4 - SFH5/16-6,30		0,313	0,551	1,250	6,299	1,535	M6x1,0mm
VS054	ST1-1/4 - SFH3/8-6,30		0,375	0,945	1,250	6,299	1,654	M8x1,0mm
VS055	ST1-1/4 - SFH1/2-6,30		0,500	0,945	1,250	6,299	1,850	M10x1,0mm
VS056	ST1-1/4 - SFH5/8-6,30		0,625	1,063	1,250	6,299	1,969	M12x1,0mm
VS057	ST1-1/4 - SFH3/4-6,30		0,750	1,063	1,250	6,299	2,047	M16x1,0mm

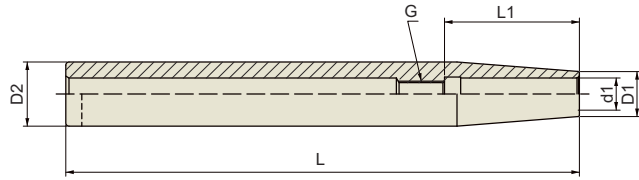

## ■ METRIC(STANDARD)

Unit : mm

EDP No.	TAPER No.	MODEL No.	d1	D1	D2	L	L1	G
VS010M	12	ST12-SFH3-120	3	8	12	120	10	-
VS011M		ST12-SFH4-120	4	8	12	120	12	-
VS012M		ST12-SFH5-120	5	10	12	120	15	-
VS013M		ST12-SFH6-120	6	10	12	120	36	M5×0,8mm
VS020M	16	ST16-SFH3-120	3	10	16	120	10	-
VS021M		ST16-SFH4-120	4	10	16	120	12	-
VS022M		ST16-SFH5-120	5	10	16	120	15	-
VS023M		ST16-SFH6-120	6	10	16	120	36	M5×0,8mm
VS024M		ST16-SFH8-120	8	12	16	120	36	M6×1,0mm
VS030M	20	ST20-SFH3-120	3	10	20	120	10	-
VS031M		ST20-SFH4-120	4	10	20	120	12	-
VS032M		ST20-SFH5-120	5	10	20	120	15	-
VS033M		ST20-SFH6-120	6	10	20	120	36	M5×0,8mm
VS034M		ST20-SFH8-120	8	12	20	120	36	M6×1,0mm
VS035M		ST20-SFH10-120	10	14	20	120	43	M8×1,0mm
VS036M	ST20-SFH12-120	12	16	20	120	48	M10×1,0mm	

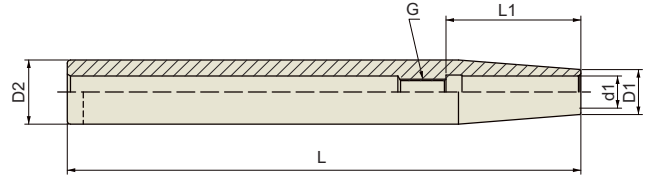

## ■ METRIC(EXTENDED)

Unit : mm

EDP No.	TAPER No.	MODEL No.	d1	D1	D2	L	L1	G
VS110M	12	ST12-SFH3-160	3	8	12	160	10	--
VS111M		ST12-SFH4-160	4	8	12	160	12	--
VS112M		ST12-SFH5-160	5	10	12	160	15	--
VS113M		ST12-SFH6-160	6	10	12	160	36	M5×0,8mm
VS210M	16	ST16-SFH3-160	3	10	16	160	10	--
VS211M		ST16-SFH4-160	4	10	16	160	12	--
VS212M		ST16-SFH5-160	5	10	16	160	15	--
VS213M		ST16-SFH6-160	6	10	16	160	36	M5×0,8mm
VS214M		ST16-SFH8-160	8	12	16	160	36	M6×1,0mm
VS310M	20	ST20-SFH3-160	3	10	20	160	10	--
VS311M		ST20-SFH4-160	4	10	20	160	12	--
VS312M		ST20-SFH5-160	5	10	20	160	15	--
VS313M		ST20-SFH6-160	6	10	20	160	36	M5×0,8mm
VS314M		ST20-SFH8-160	8	12	20	160	36	M6×1,0mm
VS315M		ST20-SFH10-160	10	14	20	160	43	M8×1,0mm
VS316M	ST20-SFH12-160	12	16	20	160	48	M10×1,0mm	
VS410M	25	ST25-SFH3-160	3	10	25	160	10	--
VS411M		ST25-SFH4-160	4	10	25	160	12	--
VS412M		ST25-SFH5-160	5	15	25	160	15	--
VS413M		ST25-SFH6-160	6	20	25	160	36	M5×0,8mm
VS414M		ST25-SFH8-160	8	20	25	160	36	M6×1,0mm
VS415M		ST25-SFH10-160	10	20	25	160	43	M8×1,0mm
VS416M		ST25-SFH12-160	12	20	25	160	48	M10×1,0mm
VS417M		ST25-SFH14-160	14	20	25	160	48	M10×1,0mm
VS418M	ST25-SFH16-160	16	22	25	160	51	M12×1,0mm	
VS510M	32	ST32-SFH6-160	6	20	32	160	36	M5×0,8mm
VS511M		ST32-SFH8-160	8	20	32	160	36	M6×1,0mm
VS512M		ST32-SFH10-160	10	24	32	160	43	M8×1,0mm
VS513M		ST32-SFH12-160	12	24	32	160	48	M10×1,0mm
VS514M		ST32-SFH14-160	14	27	32	160	48	M10×1,0mm
VS515M		ST32-SFH16-160	16	27	32	160	51	M12×1,0mm
VS516M		ST32-SFH18-160	18	27	32	160	51	M12×1,0mm
VS517M		ST32-SFH20-160	20	27	32	160	53	M16×1,0mm